

Rebroadcasting from Frontrow JUNO to Roger Touch Transmitter



01823 323363
info@robertsaudiosolutions.co.uk
www.robertsaudiosolutions.co.uk



Audio out

Audio input

- Using a 3.5mm jack to jack lead connect to the AUDIO OUTPUT from the JUNO,
- With the other end of the lead connect the Roger transmitter using the AUDIO INPUT at the base of the transmitter,
- Switch on the Roger system and UNMUTE the Juno microphone,
- Whilst talking in to the JUNO microphone increase the AUDIO OUTPUT control to around volume setting 6.5,
- Ensure the hearing instrument user can hear the JUNO microphone but also the environmental sounds via the hearing aid.

Roger Touch



Audio input

JUNO Teacher Microphone

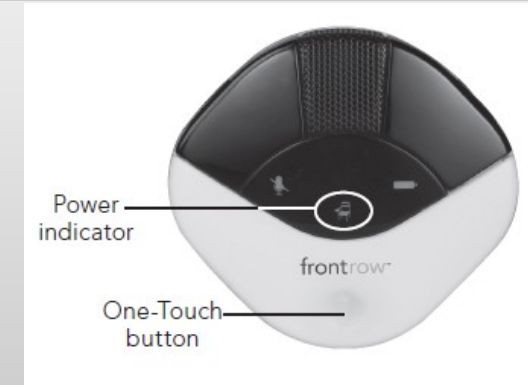

JUNO Student Microphone

