

Quick User Guide to Comfort Audio FM system - Body worn TOD version



Radio Aid description

The radio aid system is used when you are working one to one with the pupil and small group work. When working as a whole class it will need to be connected to the Soundfield system.

Soundfield description

The soundfield system is to be used when teaching the whole class. Use the teacher microphone and student microphone and ensure radio aid is con-

Components

Teachers/ TA Microphone



Pupils receiver with neckloop



Soundfield



STEP 1: Switch on microphone

Press and hold the top button and look at the screen on the back of the unit. Press until the GREEN bar has fully illuminated on the screen. Then press MUTE button on the microphone



A STEP 2: Fitting and switching on pupils receiver

Place the neckloop around hearing aid users neck and plug in to receiver as shown in diagram. Switch hearing aid to the T Position. As with the microphone press and hold the top button to switch on.

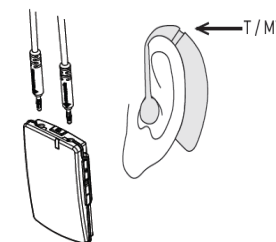

STEP 3: Wearing the microphone and receiver

Clip on microphone to clothing, the microphone works best around 30cm.

A necklace is provided if the clip is not possible to use.

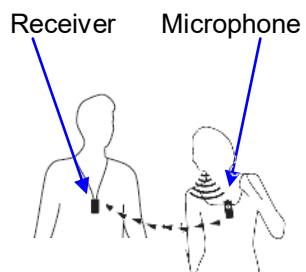

STEP 4: Increasing the volume

The volume of the neckloop can altered via the + and - switch on the side of the receiver.

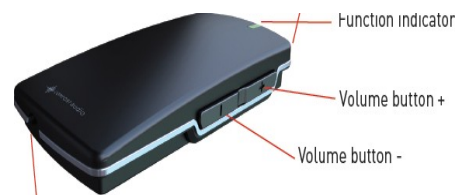

STEP 5: Charging

Plug charger in to the mains using the charger provided. The indicator will be RED when charging.

Once fully charged the indicator will go GREEN.

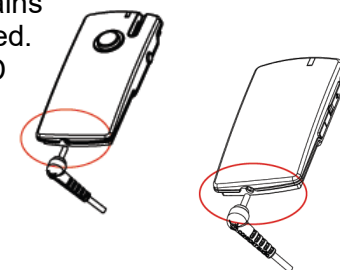

Connecting an audio source/Soundfield

An audio source can be connected e.g. White board audio. Simply find the OUTPUT from the device. This will say LINE OUT or HEADPHONE SOCKET. Use connection lead provided and connect to Audio input of the microphone.

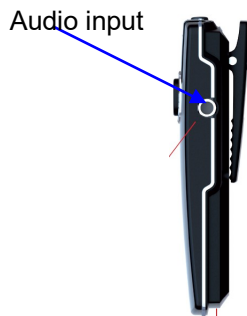

Connecting to the Soundfield

On the side of the soundfield tower connect the radio aid to ALD socket. Ensure the radio aid is not muted. Whatever microphone is used on the soundfield will be heard on the radio aid.

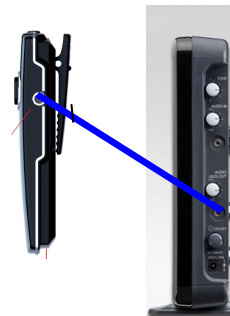

Soundfield microphone functions

On/off Switch



Microphone indicator

On/off

